

SECTION A-A

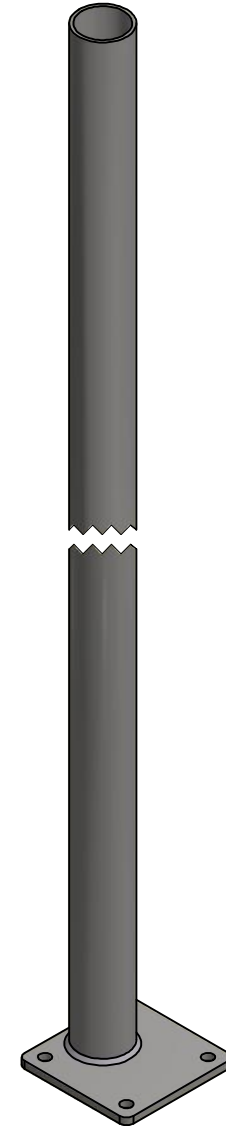

THIS DESIGN AND INFORMATION CONTAINED ON THIS PRINT IS THE PROPERTY OF VALLEY FAB CORPORATION. ANY REPRODUCTION, DUPLICATION OR TRANSFER OF THE PROPRIETARY CONTENT IS PROHIBITED WITHOUT WRITTEN PERMISSION.

STANDARD TOLERANCES:
(UNLESS OTHERWISE NOTED)
FRACTIONS ±1/16"
DECIMALS ±0.01"
ANGLES ±0.5°

NEWAVE
TOWER COMPONENTS. 503-792-3739
10910 PORTLAND RD. BROOKS, OR 97305

TOTAL WT: 109.55 LB

QTY:

FINISH: HDG

JOB #:

| ITE | PART # | QTY | DESCRIPTION | LENGTH | FINISH | UNIT W |
|-----|-----------|-----|------------------------------------|--------|--------|--------|
| 1 | BSP134.01 | 1 | 3" STD BARE PIPE @ 13'-4" LONG | | | 101.12 |
| 2 | BSP-P2 | 1 | 1/2" BASE SHOE POST PLATE (OFFSET) | | BARE | 8.35 |

TITLE: 4-HOLE BASE SHOE POST
3-1/2" O.D. x 13'-4" COLUMN

SERIES: COAX ICE BRIDGE SHEET: 1 OF 1

DRAWN BY: JG DATE: 7/17/2018 CHK'D BY:
DRAWING NO. BSP1344H