

Mark	Qty	Description	Length	Part Lbs
	2	UB38X2X4G	4 3/8"	0
	2	SFW3-1116G	3"	0
WP-SCAM-110-1A	1	HSS 3X3X3/16	1'-9 7/16"	35.508

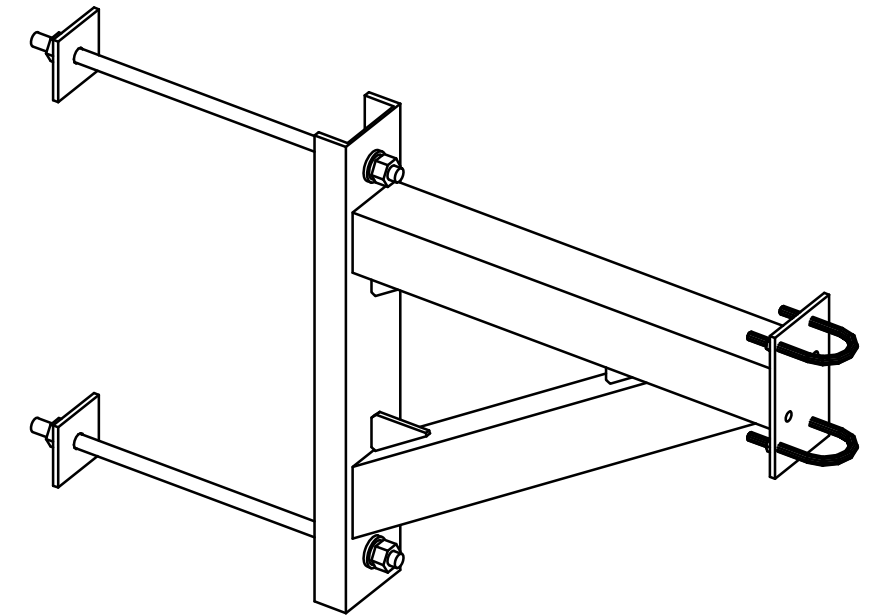

**3D VIEW**

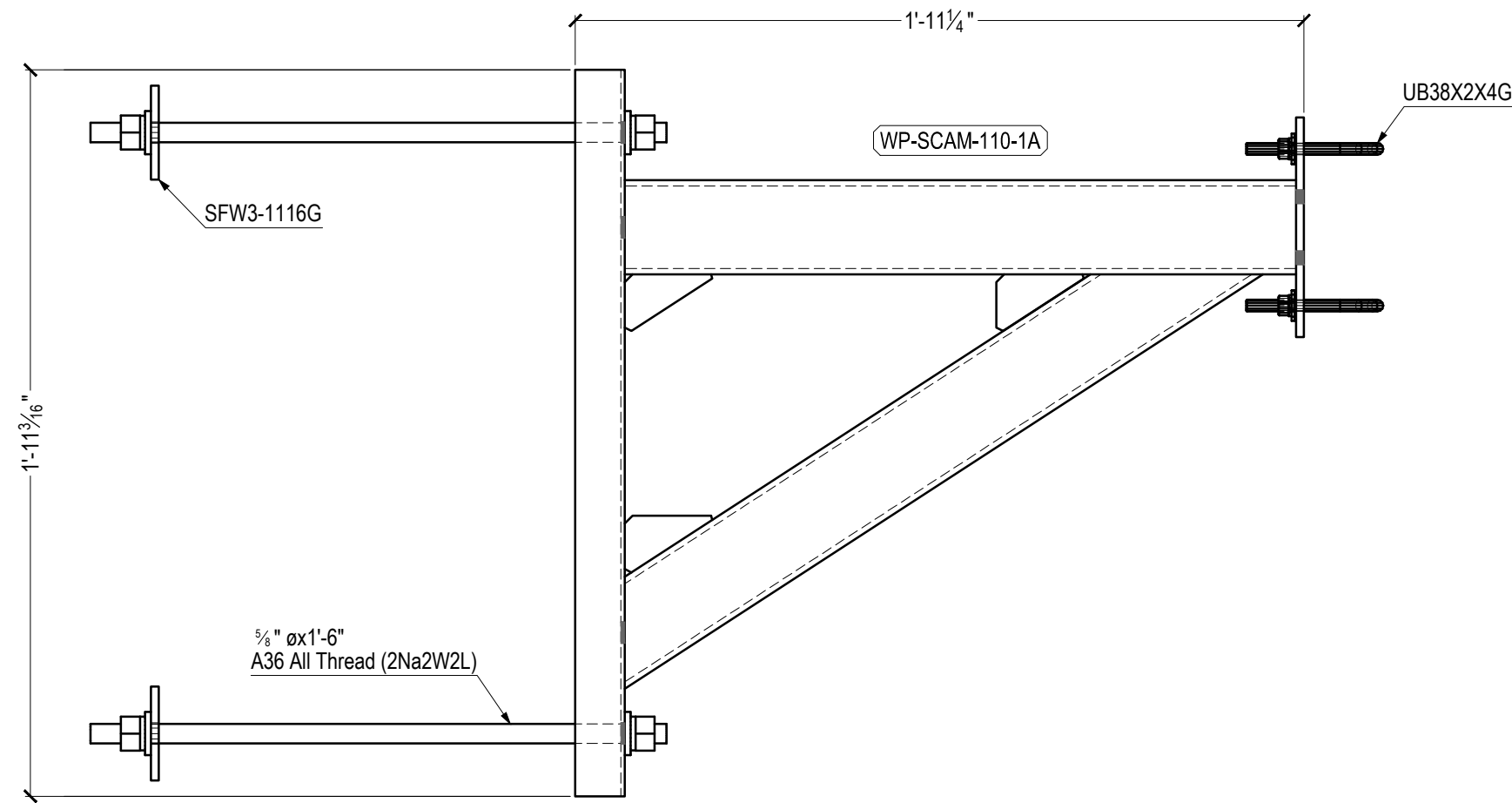

**DETAIL VIEW**

Quantity	Description	Length	Coating	Assembly
2	A36 5/8 x 18 All Thread	1'-6"	Galvanized	2Na2W2L

**\* ATTENTION \***

THESE ARE 100% WORKING DRAWINGS AND ARE INTENDED FOR FABRICATION UPON RELEASE FROM THE GENERAL CONTRACTOR. THEREFORE, ALL REQUIRED APPROVAL STAMPS MUST APPEAR ON ALL SHOP DRAWINGS OR WORK WILL NOT PROCEED. THESE DRAWINGS ARE TO THE BEST INTERPRETATION OF THE CONTRACT DOCUMENTS. THEREFORE ANY ERRORS ON THE ORIGINAL DRAWINGS ARE NOT THE FAULT OF THE DETAILER OR STEEL FABRICATOR. IT'S THE RESPONSIBILITY OF THE APPROVER(S) TO VERIFY AND CORRECT ANY DIMENSIONS, MATERIALS, AND SECTION VIEWS. IF MATERIALS AND DIMENSIONS ARE NOT CORRECTED IN THE APPROVAL PROCESS WE ASSUME THAT THEY ARE CORRECT AND ARE NOT LIABLE FOR ANY EXPENSE FOR CORRECTIONS THEREAFTER.

THIS DRAWING CONTAINS PROPRIETARY INFORMATION AND MAY NOT BE COPIED, REPRODUCED OR DISTRIBUTED WITHOUT THE CONSENT OF NEWAVE TOWER COMPONENTS.  
© 2017 Newave Tower Components.

**NEWAVE** NEWAVE TOWER COMPONENTS  
10910 PORTLAND RD. NE. BROOKS, OR. 97305  
PH: (503) 792-3739 FAX: (503) 792-3738  
NEWAVETC.COM

PROJECT:  
**SMALL CELL ANTENNA WOODPOLE MOUNT**

Index	Date	Author	Description

STANDARD TOLERANCES:			
FRACTIONAL ±1/16", DECIMALS ±.005", ANGLES ±.5°			
STANDARD GRADES & WELDING ELECTRODE (UNO):			
PLATE:A36, ANGLE:A36; C-SHAPE:A36 WF:A992, HSS:A500B, PIPE:A53B, E70XX			
CHK'D BY:	DATE:	SCALE:	FINISH:
CJW	4/5/2021	NTS	Galvanized
DRAWN BY:	DATE:	PROJECT No:	DRAWING No: REV:
CJW	4/5/2021	WP-SCAM-110	- 0