

FRONT VIEW

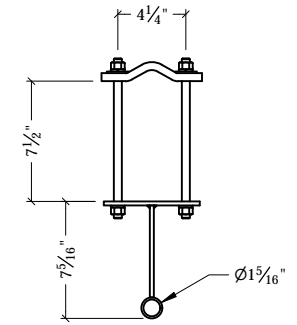

TOP VIEW

ITEM	PART #	QTY	DESCRIPTION	LENGTH	FINISH	UNIT WT
1	GPSWM.01	1	GPS WALL MOUNT WELDMENT, 42"		HDG	9.62
2	AMCS-3.01	2	1/2" PLATE		SEE W/O	1.26
3	25- TR12-10	4	1/2" x 10" B7 HDG ALL-THREAD	10"		0.56
4	27-5200-005	4	1/2 A36 HDG FLAT WASHER			0.04
5	27-5210-005	8	1/2 HDG LOCK WASHER			0.01
6	27-5222-005	8	1/2 HDG HEX NUT			0.04

<b>TITLE:</b> GPS WALL MOUNT 42" HEIGHT (HOLLOW WALL)			<b>DRAWN BY:</b> JG	<b>DATE:</b> 7/17/2018	<b>CHK'D BY:</b>
<b>SERIES:</b> ROOFTOP/WALL MOUNT			<b>DRAWING NO.:</b> GPSWM-H		
<b>SHEET:</b> 1 OF 1					

THIS DESIGN AND INFORMATION CONTAINED ON THIS PRINT IS THE PROPERTY OF VALLEY FAB CORPORATION. ANY REPRODUCTION, DUPLICATION OR TRANSFER OF THE PROPRIETARY CONTENT IS PROHIBITED WITHOUT WRITTEN PERMISSION.

**STANDARD TOLERANCES:**  
(UNLESS OTHERWISE NOTED)  
FRACTIONS - 1/16"  
DECIMALS - 0.01"  
ANGLES - 0.5°

**NEWAVE**  
Tower Components. 503-792-3739  
10910 PORTLAND RD. BROOKS, OR 97305

**TOTAL WT:** 14.95 LB  
**QTY:**  
**FINISH:**  
**JOB #:**